



**Where:**

American Airlines Training and Conference Center  
4501 Highway 360 S. | Mail Drop 929 | Fort Worth, TX 76155

**When:**

October 4-5, 2013

**Exhibitor Hours:**

Friday, October 4  
Saturday, October 5

**2013 Booth Fees:**

Each standard booth space cost \$2500

**Shipping and Receiving:**

Due to limitations in secured storage space, the American Airlines Training & Conference Center will only accept packages as follows:

- Boxes/packages may be sent for arrival a maximum of 48 hours prior to group arrival and will be marked with the responsible party's name, group name, plus "Hold for Arrival Date of October 24, 2012".
- There will be a handling charge as follows:
  - o Packages 50 lbs. and Under                      \$5.00/each (Incoming and Outgoing)
  - o Packages Over 51 lbs.                              \$25.50/each (Incoming and Outgoing)
  - o Pallets    \$250.00/each (Incoming and Outgoing)

For other sized amounts, please consult your AAOSDI Director of Operations for pricing.



### **Deliveries to Rooms:**

There will be a handling charge of \$2.00 per small box, basket, bag or other item to each room.

### **Transportation:**

Complimentary transportation of individuals is available to and from Dallas/Fort Worth International Airport.

The concierge will gladly assist guests arrange other local transportation for individuals.

### **Signage:**

Signs and banners are not allowed in AATCC's public areas without our prior written permission. Nothing may be posted, nailed, screwed or otherwise attached to walls, floors, or other parts of the building or furniture.

### **Booth Space:**

Booths are 8' x 10' and include the following:  
5' x 2' table with table cloth and two chairs  
Trash Receptacle  
Electrical

### **Contact Us:**

The American Academy of Small Diameter Implants is here to answer all your question. If it's not on our website, please email or give us a call.

Email: [jmoore@aaosdi.com](mailto:jmoore@aaosdi.com)  
Office: 817.560.0414  
Mobile: 843.283.7999



**Tentative Agenda  
10/4/2013**

Breakfast Learn Company Sponsored	7:30am-8:30am
Lecture Ara Nazarian, DDS Flagship Auditorium	8:30am-10:00am
Exhibitor Break Atrium	10:00am-10:30am
Lecture Ara Nazarian, DDS Flagship Auditorium	10:30am-12:00pm
Lunch Learn Company Sponsored	12:00pm-1:30pm
Lecture Ara Nazarian, DDS Flagship Auditorium	1:30pm-3:00pm
Exhibitor Break Atrium	3:00pm-3:30pm
Lecture Ara Nazarian, DDS Flagship Auditorium	3:30pm-5:00pm
Exhibitor Break Atrium	5:00pm-6:00pm
Awards Reception Academy Sponsored	6:00pm-7:00pm



**Tentative Agenda  
10/5/2013**

Breakfast Learn Company Sponsored	7:30am-8:30am
Lecture Guest Speaker TBA Flagship Auditorium	8:30am-10:00am
Exhibitor Break Atrium	10:00am-10:30am
Lecture Guest Speaker TBA Flagship Auditorium	10:30am-12:00pm
Lunch Learn Company Sponsored	12:00pm-1:30pm
Lecture Guest Speaker TBA Flagship Auditorium	1:30pm-3:00pm
Exhibitor Break Atrium	3:00pm-3:30pm
Lecture Guest Speaker TBA Flagship Auditorium	3:30pm-5:00pm

Everyone departs.  
Travel safely and see you all next year!

## Enlarged Exhibit Hall “The Atrium”

1	2	3	4	5	11	12	13	14
6	7	8	9	10	15	16	17	18

From Parking Lot

To Mercury Wing

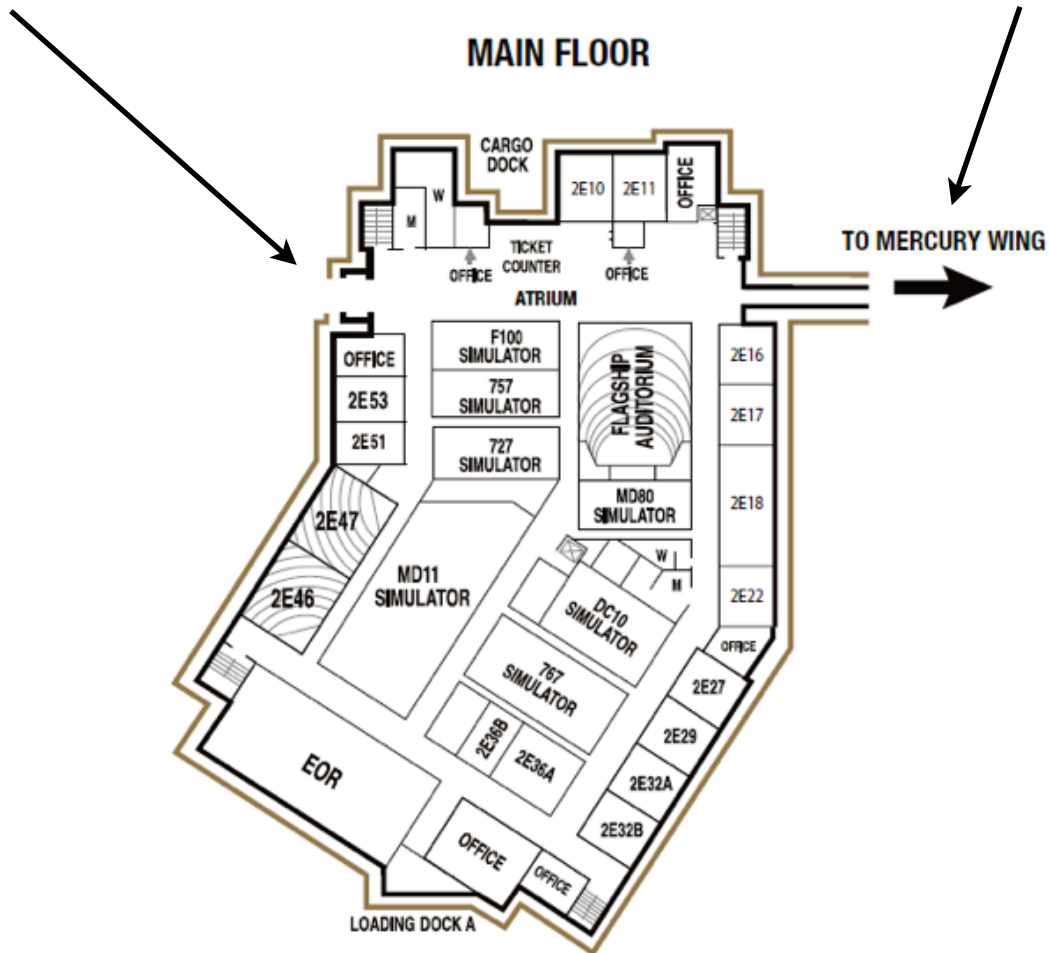

**Flagship Auditorium:**  
Main Meeting Room

**Atrium:**  
Exhibit Hall

**Mercury Wing:**  
Breakfast and Lunch n’ Learns

500 8th Avenue, Ste. 100  
Fort Worth, Texas 76104  
843-283-7999  
[www.aaosdi.com](http://www.aaosdi.com)



**Exhibitor Application**

Date of Application: \_\_\_\_\_

***Company Information***

Name: \_\_\_\_\_

Address: \_\_\_\_\_ State \_\_\_\_\_ Zip \_\_\_\_\_

Primary Contact: \_\_\_\_\_ Email \_\_\_\_\_

Primary Contact Cell Phone Number: \_\_\_\_\_

Office Phone: \_\_\_\_\_

Alternative Phone: \_\_\_\_\_ Email: \_\_\_\_\_

Website Address: \_\_\_\_\_

Booth (\$2,500)                      First Choice #: \_\_\_\_\_                      Second Choice #: \_\_\_\_\_

Breakfast & Learn                      Day 1 (\$1,500): \_\_\_\_\_                      Day 2 (\$1,000) \_\_\_\_\_

Lunch & Learn                      Day 1 (\$2,000): \_\_\_\_\_                      Day 2 (\$1,500) \_\_\_\_\_

*Company Bio (250 words or less)*

***Payment***

Credit card information for payment of application fee is required when the application is submitted.

Check # \_\_\_\_\_

Credit Card (Check One):  Visa     MasterCard     Amex     Discover    Expiration Date: \_\_\_\_/\_\_\_\_

Credit Card # \_\_\_\_\_ Security Code: \_\_\_\_\_